

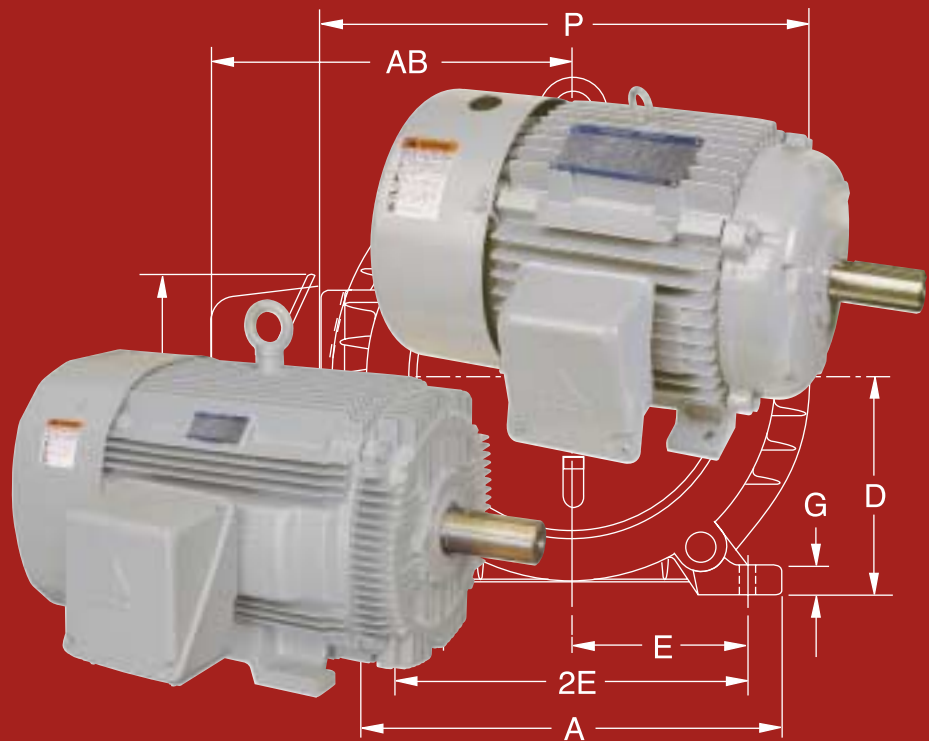

Crown Triton™ Series Inverter Shield™

- Premium Efficiency, TEFC Enclosure
- Variable Speed Motors
- Corona Resistant Magnetic Wire



5 year warranty
CSA certified
NEMA MG 1, PART 31
VFD duty

“Experience Combined with Technology”

Hyundai Induction Motors use Finite Element Analysis (FEA) and Computer Aided Design (CAD) methods to develop and produce the most innovative motors from state-of-the-art and fully automated manufacturing facilities.

Hyundai's Crown Triton™ cast iron frames sharply improve motor performance by maximizing heat dissipation.

The use of advanced technology to design and produce electric motors allows the motor design to be maximized in both performance and cost, providing the market with a superior quality product at a reasonable price.

Compared with normal efficiency motors, Hyundai's Crown Triton™ Inverter Shield™ Premium efficiency motors guarantee better performance.

- Approvals : CSA, CSA C US, EEV mark



Foot Mounted Motors



Inverter Shield™ Premium Efficiency TEFC, Crown Triton™ Series, VFD Duty

- Variable torque (0 to base speed) & 10:1 Constant torque
- Hyundai's Inverter Shield low stress insulation system
- Cast iron construction
- NEMA design B or C torque
- Class F insulation
- Premium efficiency, exceeds CSA C390 requirements
- NEMA MG 1, PART 31

Outline Dimensions in Inches

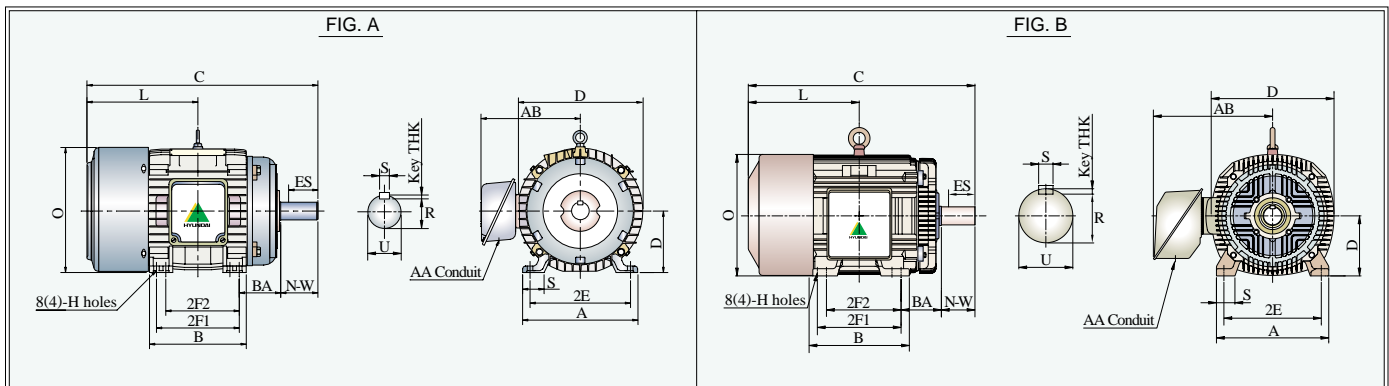

| Frame Size | Overall | | | | | Mounting | | | Conduit Box | | Shaft | | Key | | | Fig. |
|------------|---------|-------|-------|-------|-------|----------|---------|---------|-------------|-------|-------|--------|----------|---------|--------|------|
| | BA | C | D | O | P | 2E | 2F1 | 2F2 | AA | AB | U | N-W | Keyway R | S (SQ.) | Length | |
| 143T | 2.25 | 12.88 | 3.50 | 7.44 | 7.44 | 5.50 | (5.00) | 4.00 | 0.75 | 6.46 | 0.875 | 2.250 | 0.771 | 0.188 | 1.410 | A |
| 145T | 2.25 | 12.88 | 3.50 | 7.44 | 7.44 | 5.50 | 5.00 | (4.00) | 0.75 | 6.46 | 0.875 | 2.250 | 0.771 | 0.188 | 1.410 | |
| 182T | 2.75 | 14.69 | 4.50 | 9.45 | 9.89 | 7.50 | 4.50 | - | 0.75 | 7.75 | 1.125 | 2.750 | 0.986 | 0.250 | 1.780 | |
| 184T | 2.75 | 15.69 | 4.50 | 9.45 | 9.89 | 7.50 | 5.50 | (4.50) | 0.75 | 7.75 | 1.125 | 2.750 | 0.986 | 0.250 | 1.780 | |
| 213T | 3.50 | 18.33 | 5.25 | 11.00 | 11.50 | 8.50 | 5.50 | - | 1.00 | 8.50 | 1.375 | 3.380 | 1.201 | 0.312 | 2.410 | |
| 215T | 3.50 | 19.83 | 5.25 | 11.00 | 11.50 | 8.50 | 7.00 | (5.50) | 1.00 | 8.50 | 1.375 | 3.380 | 1.201 | 0.312 | 2.410 | |
| 254T | 4.25 | 23.52 | 6.25 | 13.08 | 13.65 | 10.00 | 8.25 | - | 1.25 | 12.30 | 1.625 | 4.000 | 1.416 | 0.375 | 2.910 | |
| 256T | 4.25 | 25.25 | 6.25 | 13.08 | 13.65 | 10.00 | 10.00 | (8.25) | 1.25 | 12.30 | 1.625 | 4.000 | 1.416 | 0.375 | 2.910 | |
| 284TS | 4.75 | 25.50 | 7.00 | 14.74 | 15.48 | 11.00 | 9.50 | - | 1.50 | 12.87 | 1.625 | 3.250 | 1.416 | 0.375 | 1.910 | |
| 284T | 4.75 | 26.87 | 7.00 | 14.74 | 15.48 | 11.00 | 9.50 | - | 1.50 | 12.87 | 1.875 | 4.620 | 1.591 | 0.500 | 3.280 | |
| 286TS | 4.75 | 27.00 | 7.00 | 14.74 | 15.48 | 11.00 | 11.00 | (9.50) | 1.50 | 12.87 | 1.625 | 3.250 | 1.416 | 0.375 | 1.910 | |
| 286T | 4.75 | 28.37 | 7.00 | 14.74 | 15.48 | 11.00 | 11.00 | (9.50) | 1.50 | 12.87 | 1.875 | 4.620 | 1.591 | 0.500 | 3.280 | |
| 324TS | 5.25 | 29.78 | 8.00 | 15.91 | 15.82 | 12.50 | (12.00) | 10.50 | 2.00 | 15.04 | 1.875 | 3.750 | 1.591 | 0.500 | 2.030 | |
| 324T | 5.25 | 31.28 | 8.00 | 15.91 | 15.82 | 12.50 | (12.00) | 10.50 | 2.00 | 15.04 | 2.125 | 5.250 | 1.845 | 0.500 | 3.910 | |
| 326TS | 5.25 | 29.78 | 8.00 | 15.91 | 15.82 | 12.50 | 12.00 | (10.50) | 2.00 | 15.04 | 1.875 | 3.750 | 1.591 | 0.500 | 2.030 | |
| 326T | 5.25 | 31.28 | 8.00 | 15.91 | 15.82 | 12.50 | 12.00 | (10.50) | 2.00 | 15.04 | 2.125 | 5.250 | 1.845 | 0.500 | 3.910 | |
| 364TS | 5.88 | 31.86 | 9.00 | 18.65 | 17.72 | 14.00 | (12.25) | 11.25 | 2.36 | 16.18 | 1.875 | 3.750 | 1.591 | 0.500 | 2.030 | |
| 364T | 5.88 | 33.99 | 9.00 | 18.65 | 17.72 | 14.00 | (12.25) | 11.25 | 2.36 | 16.18 | 2.375 | 5.880 | 2.021 | 0.625 | 4.280 | |
| 365TS | 5.88 | 31.86 | 9.00 | 18.65 | 17.72 | 14.00 | 12.25 | (11.25) | 2.36 | 16.18 | 1.875 | 3.750 | 1.591 | 0.500 | 2.030 | |
| 365T | 5.88 | 33.99 | 9.00 | 18.65 | 17.72 | 14.00 | 12.25 | (11.25) | 2.36 | 16.18 | 2.375 | 5.880 | 2.021 | 0.625 | 4.280 | |
| 404T | 6.62 | 38.94 | 10.00 | 20.95 | 19.69 | 16.00 | (13.75) | 12.25 | 3.00 | 19.72 | 2.875 | 7.250 | 2.450 | 0.750 | 5.650 | |
| 405TS | 6.62 | 35.94 | 10.00 | 20.95 | 19.69 | 16.00 | 13.75 | (12.25) | 3.00 | 19.72 | 2.125 | 4.250 | 1.845 | 0.500 | 2.800 | |
| 405T | 6.62 | 38.94 | 10.00 | 20.95 | 19.69 | 16.00 | 13.75 | (12.25) | 3.00 | 19.72 | 2.875 | 7.250 | 2.450 | 0.750 | 5.650 | |
| 444TS | 7.50 | 41.01 | 11.00 | 23.17 | 22.44 | 18.00 | (16.50) | 14.50 | 3.00 | 21.14 | 2.375 | 4.750 | 2.021 | 0.625 | 3.030 | |
| 444T | 7.50 | 44.76 | 11.00 | 23.17 | 22.44 | 18.00 | (16.50) | 14.50 | 3.00 | 21.14 | 3.375 | 8.500 | 2.880 | 0.875 | 6.930 | |
| 445TS | 7.50 | 41.01 | 11.00 | 23.17 | 22.44 | 18.00 | 16.50 | (14.50) | 3.00 | 21.14 | 2.375 | 4.750 | 2.021 | 0.625 | 3.030 | |
| 445T | 7.50 | 44.76 | 11.00 | 23.17 | 22.44 | 18.00 | 16.50 | (14.50) | 3.00 | 21.14 | 3.375 | 8.500 | 2.880 | 0.875 | 6.930 | |
| 447TS | 7.50 | 44.51 | 11.00 | 23.17 | 22.44 | 18.00 | 20.00 | (17.99) | 3.00 | 21.14 | 2.375 | 4.750 | 2.021 | 0.625 | 3.030 | |
| 447T | 7.50 | 48.28 | 11.00 | 23.17 | 22.44 | 18.00 | 20.00 | (17.99) | 3.00 | 21.14 | 3.375 | 8.500 | 2.880 | 0.875 | 6.930 | |
| 447TZ | 7.50 | 49.89 | 11.00 | 23.17 | 22.44 | 18.00 | 20.00 | (17.99) | 3.00 | 21.14 | 3.375 | 10.125 | 2.880 | 0.875 | 8.500 | |
| 449TS | 7.50 | 49.63 | 11.00 | 23.17 | 22.44 | 18.00 | 25.00 | (20.00) | 3.00 | 21.14 | 2.375 | 4.750 | 2.021 | 0.625 | 3.030 | |
| 449T | 7.50 | 53.40 | 11.00 | 23.17 | 22.44 | 18.00 | 25.00 | (20.00) | 3.00 | 21.14 | 3.375 | 8.500 | 2.880 | 0.875 | 6.930 | |
| 449TZ | 7.50 | 55.01 | 11.00 | 23.17 | 22.44 | 18.00 | 25.00 | (20.00) | 3.00 | 21.14 | 3.375 | 10.125 | 2.880 | 0.875 | 8.500 | |

Note: 1. Dimension "D" Tolerance
 140T-360T : +0.00, -0.03
 400T-440T : +0.00, -0.06

2. Dimension "U" Tolerance
 Up to 1.500 Dia. : +0.000, -0.0005
 1.625 Dia. & Larger : +0.000, -0.001

Performance Data



TEFC, Crown Triton™ Series, Inverter Shield™ Premium Efficiency Motor

Inverter duty, 3-phase, 230/460 V (usable on 208 V) , 575 V, Continuous duty
 NEMA design B or C, Class F, 40 degrees C ambient temp.
 Speed range: Variable torque (0 to base speed), Constant torque (10:1)

| Rated Output | Pole | Frame Size | Characteristics at Rated Output | | | | | | | Locked Rotor Current | | Torque | | | Moment of Inertia WK ² | NEMA Code Letter | Approx. Weight | | |
|--------------|-------|------------|---------------------------------|------------|------|----------|--------------|-------------------|--------|----------------------|--------|--------|------|-----------|-----------------------------------|------------------|----------------|--------------|------------|
| | | | Full Load Speed | Efficiency | | | Power Factor | Full Load Current | | 460V | 575V | 460V | 575V | Full Load | | | | Locked Rotor | Break-Down |
| | | | | Nom. | Min. | 3/4 Load | | Full Load | 460V | | | | | | | | | | |
| HP | | | RPM | % | % | % | % | A | A | A | A | LB.FT | %FLT | %FLT | LB.FT ² | | LBS | | |
| 1 | 4 | 143T | 1750 | 86.5 | 84.0 | 86.0 | 77.0 | 1.4 | 1.1 | 12.9 | 10.3 | 3.0 | 350 | 400 | 0.128 | M | 52 | | |
| | 6 | 145T | 1145 | 81.5 | 79.0 | 80.0 | 67.5 | 1.7 | 1.4 | 10.2 | 8.2 | 4.6 | 270 | 320 | 0.138 | K | 52 | | |
| 1.5 | 2 | 143T | 3500 | 85.5 | 83.0 | 84.0 | 85.0 | 1.9 | 1.5 | 19.1 | 15.3 | 2.3 | 300 | 375 | 0.071 | M | 52 | | |
| | 4 | 145T | 1735 | 85.5 | 83.0 | 84.0 | 81.0 | 2.0 | 1.6 | 16.2 | 13.0 | 4.5 | 300 | 330 | 0.123 | K | 53 | | |
| 2 | 6 | 182T | 1170 | 86.5 | 85.5 | 87.1 | 71.0 | 2.3 | 1.8 | 18.3 | 14.3 | 6.7 | 220 | 340 | 0.370 | L | 97 | | |
| | 2 | 145T | 3500 | 85.5 | 83.0 | 85.0 | 85.0 | 2.6 | 2.1 | 20.8 | 16.6 | 3.0 | 310 | 320 | 0.071 | K | 52 | | |
| | 4 | 145T | 1735 | 85.5 | 83.0 | 84.5 | 79.5 | 2.8 | 2.2 | 21.7 | 17.4 | 6.1 | 305 | 355 | 0.138 | K | 53 | | |
| 3 | 6 | 184T | 1165 | 87.5 | 86.5 | 88.6 | 73.5 | 2.9 | 2.3 | 21.8 | 17.3 | 9.0 | 210 | 310 | 0.370 | K | 101 | | |
| | 2 | 182T | 3530 | 87.5 | 86.5 | 86.3 | 87.0 | 3.7 | 3.0 | 26.9 | 21.9 | 4.5 | 240 | 340 | 0.147 | J | 96 | | |
| | 4 | 182T | 1760 | 88.5 | 87.5 | 88.6 | 80.0 | 4.0 | 3.1 | 29.8 | 23.3 | 9.0 | 240 | 350 | 0.308 | J | 93 | | |
| 5 | 6 | 213T | 1175 | 88.5 | 87.5 | 89.7 | 74.0 | 4.3 | 3.4 | 32.0 | 25.4 | 13.4 | 220 | 300 | 1.125 | K | 172 | | |
| | 2 | 184T | 3515 | 89.5 | 88.5 | 90.2 | 88.0 | 5.9 | 4.8 | 43.4 | 35.0 | 7.5 | 205 | 320 | 0.197 | H | 111 | | |
| | 4 | 184T | 1755 | 89.5 | 88.5 | 91.3 | 82.0 | 6.4 | 5.1 | 46.0 | 36.8 | 15.0 | 250 | 330 | 0.411 | J | 109 | | |
| 7.5 | 6 | 215T | 1170 | 89.5 | 88.5 | 89.8 | 75.0 | 7.0 | 5.6 | 46.0 | 36.9 | 22.4 | 240 | 300 | 1.220 | J | 186 | | |
| | 2 | 213T | 3530 | 91.0 | 90.2 | 92.6 | 86.5 | 8.9 | 7.1 | 63.5 | 50.5 | 11.2 | 155 | 275 | 0.363 | G | 153 | | |
| | 4 | 213T | 1765 | 91.7 | 91.0 | 92.5 | 82.0 | 9.3 | 7.5 | 60.7 | 48.8 | 22.3 | 230 | 250 | 1.032 | H | 166 | | |
| 10 | 6 | 254T | 1180 | 91.7 | 90.4 | 92.4 | 72.0 | 10.6 | 8.5 | 63.3 | 50.6 | 33.4 | 200 | 250 | 2.259 | H | 301 | | |
| | 2 | 215T | 3520 | 91.7 | 91.0 | 93.6 | 88.5 | 11.5 | 9.2 | 75.0 | 59.8 | 14.9 | 180 | 270 | 0.524 | G | 190 | | |
| | 4 | 215T | 1765 | 91.7 | 91.0 | 92.7 | 82.0 | 12.5 | 10.0 | 78.4 | 63.0 | 29.8 | 230 | 250 | 1.125 | H | 179 | | |
| 15 | 6 | 256T | 1175 | 91.7 | 90.4 | 92.7 | 72.0 | 14.2 | 11.3 | 79.4 | 63.3 | 44.7 | 210 | 245 | 2.432 | H | 353 | | |
| | 2 | 254T | 3545 | 91.7 | 91.0 | 92.7 | 89.0 | 17.2 | 13.8 | 111.9 | 89.7 | 22.2 | 180 | 270 | 1.196 | G | 300 | | |
| | 4 | 254T | 1770 | 92.4 | 91.7 | 93.4 | 82.5 | 18.4 | 14.7 | 116.0 | 92.6 | 44.5 | 200 | 240 | 2.432 | G | 305 | | |
| 20 | 6 | 284T | 1180 | 91.7 | 91.0 | 92.4 | 82.0 | 18.7 | 14.9 | 116.0 | 92.5 | 66.8 | 200 | 230 | 8.116 | G | 435 | | |
| | 2 | 256T | 3540 | 92.4 | 91.7 | 93.7 | 90.0 | 22.5 | 18.0 | 141.9 | 113.4 | 29.7 | 170 | 270 | 1.609 | G | 366 | | |
| | 4 | 256T | 1765 | 93.0 | 92.4 | 94.1 | 83.0 | 24.3 | 19.4 | 140.7 | 112.5 | 59.5 | 210 | 230 | 3.040 | G | 358 | | |
| 25 | 6 | 286T | 1180 | 92.4 | 91.7 | 93.6 | 81.5 | 24.9 | 19.9 | 144.2 | 115.4 | 89.0 | 200 | 230 | 8.116 | G | 437 | | |
| | 2 | 284TS | 3560 | 93.0 | 92.4 | 93.8 | 91.0 | 27.7 | 22.1 | 179.8 | 143.7 | 36.9 | 185 | 250 | 3.351 | G | 450 | | |
| | 4 | 284T | 1770 | 93.6 | 93.0 | 94.4 | 83.5 | 30.0 | 24.0 | 182.5 | 146.2 | 74.2 | 190 | 230 | 4.222 | G | 465 | | |
| 30 | 6 | 324T | 1180 | 93.0 | 92.4 | 92.8 | 81.0 | 31.1 | 24.9 | 182.5 | 146.2 | 111.3 | 200 | 230 | 13.288 | G | 573 | | |
| | 2 | 286TS | 3555 | 93.0 | 92.4 | 94.1 | 91.0 | 33.2 | 26.6 | 215.7 | 172.9 | 44.3 | 180 | 240 | 3.351 | G | 452 | | |
| | 4 | 286T | 1775 | 93.6 | 93.0 | 94.8 | 84.0 | 35.7 | 28.6 | 217.5 | 174.1 | 88.8 | 210 | 230 | 4.824 | G | 481 | | |
| 40 | 6 | 326T | 1180 | 93.6 | 92.5 | 93.4 | 82.0 | 36.6 | 29.3 | 217.5 | 174.1 | 133.5 | 200 | 230 | 17.086 | G | 575 | | |
| | 2 | 324TS | 3560 | 93.6 | 93.0 | 92.7 | 89.0 | 45.0 | 36.0 | 287.7 | 230.4 | 59.0 | 160 | 220 | 5.410 | G | 511 | | |
| | 4 | 324T | 1770 | 94.1 | 93.2 | 93.6 | 84.0 | 47.4 | 37.9 | 279.6 | 223.6 | 118.7 | 190 | 240 | 9.777 | G | 558 | | |
| 50 | 6 | 364T | 1180 | 94.1 | 93.1 | 94.0 | 85.0 | 46.8 | 37.7 | 290.0 | 232.0 | 178.0 | 200 | 250 | 29.180 | G | 870 | | |
| | 2 | 326TS | 3560 | 93.6 | 93.0 | 92.7 | 89.5 | 55.9 | 44.7 | 362.5 | 289.9 | 73.8 | 160 | 230 | 6.075 | G | 513 | | |
| | 4 | 326T | 1770 | 94.1 | 93.2 | 93.6 | 84.5 | 58.9 | 47.1 | 353.3 | 282.6 | 148.4 | 200 | 250 | 13.288 | G | 581 | | |
| 60 | 6 | 365T | 1180 | 94.1 | 93.1 | 94.1 | 85.0 | 58.5 | 46.4 | 362.5 | 290.0 | 222.5 | 200 | 250 | 35.120 | G | 930 | | |
| | 2 | 364TS | 3540 | 94.1 | 93.0 | 94.0 | 91.0 | 65.6 | 52.8 | 435.0 | 348.0 | 89.0 | 120 | 200 | 13.910 | G | 870 | | |
| | 4 | 364T | 1775 | 95.0 | 94.1 | 95.2 | 86.0 | 68.8 | 55.3 | 435.0 | 348.0 | 177.5 | 200 | 250 | 21.000 | G | 870 | | |
| 75 | 6 | 404T | 1180 | 94.1 | 93.1 | 94.3 | 86.0 | 69.4 | 55.8 | 435.0 | 348.0 | 267.1 | 200 | 250 | 56.410 | G | 1380 | | |
| | 2 | 365TS | 3540 | 94.1 | 93.6 | 94.0 | 92.0 | 81.1 | 63.8 | 542.5 | 434.0 | 111.3 | 120 | 200 | 15.660 | G | 930 | | |
| | 4 | 365T | 1775 | 95.0 | 94.5 | 95.2 | 86.0 | 85.9 | 67.6 | 542.5 | 434.0 | 221.9 | 200 | 250 | 24.170 | G | 930 | | |
| 100 | 6 | 405T | 1180 | 94.1 | 93.6 | 94.3 | 86.0 | 86.8 | 68.2 | 542.5 | 434.0 | 333.8 | 200 | 250 | 60.030 | G | 1410 | | |
| | 2 | 405TS | 3550 | 95.0 | 94.1 | 95.0 | 90.0 | 109.5 | 88.1 | 725.0 | 580.0 | 147.9 | 110 | 200 | 27.140 | G | 1410 | | |
| | 4 | 405T | 1775 | 95.0 | 94.5 | 95.1 | 86.5 | 113.9 | 91.6 | 725.0 | 580.0 | 295.9 | 200 | 250 | 43.470 | G | 1410 | | |
| 125 | 6 | 444T | 1180 | 95.0 | 94.1 | 95.2 | 86.0 | 114.6 | 92.2 | 725.0 | 580.0 | 445.1 | 200 | 250 | 84.430 | G | 1720 | | |
| | 2 | 444TS | 3555 | 95.0 | 94.3 | 95.0 | 90.0 | 136.9 | 109.2 | 910.0 | 728.0 | 184.7 | 100 | 200 | 43.600 | G | 1720 | | |
| | 4 | 444T | 1778 | 95.4 | 94.5 | 95.1 | 87.5 | 140.2 | 111.9 | 910.0 | 728.0 | 369.2 | 200 | 250 | 64.090 | G | 1720 | | |
| 150 | 6 | 445T | 1180 | 95.0 | 94.1 | 95.2 | 86.5 | 142.4 | 113.6 | 910.0 | 728.0 | 556.4 | 200 | 250 | 98.140 | G | 2010 | | |
| | 2 | 445TS | 3565 | 95.0 | 94.3 | 95.0 | 90.0 | 164.3 | 129.2 | 1085.0 | 868.0 | 221.0 | 100 | 200 | 49.840 | G | 2010 | | |
| | 4 | 445T | 1780 | 95.4 | 94.5 | 95.5 | 88.0 | 167.3 | 131.6 | 1085.0 | 868.0 | 442.6 | 200 | 250 | 80.700 | G | 2010 | | |
| 200 | 6 | 447TZ | 1180 | 95.0 | 94.1 | 95.0 | 86.5 | 170.9 | 134.4 | 1085.0 | 868.0 | 667.6 | 200 | 250 | 117.330 | G | 2230 | | |
| | 2 | 447TS | 3565 | 95.4 | 94.5 | 95.2 | 91.0 | 215.7 | 173.5 | 1450.0 | 1160.0 | 294.6 | 100 | 200 | 56.970 | G | 2230 | | |
| | 4 | 447TZ | 1780 | 95.8 | 95.0 | 95.4 | 88.0 | 222.1 | 178.7 | 1450.0 | 1160.0 | 590.1 | 200 | 250 | 86.670 | G | 2230 | | |
| 250 | 6 | 449TZ | 1180 | 95.4 | 94.1 | 95.5 | 87.0 | 225.6 | 181.5 | 1450.0 | 1160.0 | 890.2 | 200 | 220 | 178.450 | G | 2910 | | |
| | 2 | 449TS | 3565 | 95.4 | 94.5 | 95.5 | 91.5 | 268.2 | 215.1 | 1825.0 | 1460.0 | 368.3 | 100 | 200 | 81.990 | G | 2910 | | |
| 4 | 449TZ | 1780 | 95.8 | 95.0 | 96.0 | 88.5 | 276.1 | 221.5 | 1825.0 | 1460.0 | 737.7 | 200 | 220 | 130.270 | G | 2910 | | | |

Note: 1. The above data are average expected values (performance data are based on sine wave tests).
 2. Actual minimum efficiencies can be certified by direct measurement based on ANSI/IEEE 112 test method B and CSA C 390.
 3. Technical data are subject to change without notice.
 4. 150HP and above are single voltage (460V or 575V) only.

Crown Triton™ Series Inverter Shield™

Production Range

- Frame size : 143T to 449TZ
- Horsepower : 1 to 250 HP
- Poles : 2, 4, 6 pole
- Enclosure : TEFC, IP54 Protection
Rigid cast iron construction

Typical Features

- Premium Efficiency
- Hyundai's Inverter Shield Insulation System
- Variable torque (0 to base speed), Constant torque (10:1)
- Suitable for 1.5 times base speed, constant HP (subject to mechanical limits)
- Class F insulation (inverter duty wire)
- 5 year warranty
- Bearings rated 100,000 hours L10 for direct coupled duty and 50,000 hours L10 for belted duty
- Quiet running
-minimizing noise and vibration
- Dual rated service factors
1.15 at 40 degrees C ambient &
1.0 at 65 degrees C ambient (sine wave) SF
1.0 (P.W.M. power) at 40 degrees C ambient
- Approvals
-CSA, CSA C US, EEV mark
- Exceeds NEMA MG 1, Part 31
- C-face and D-flange kits available

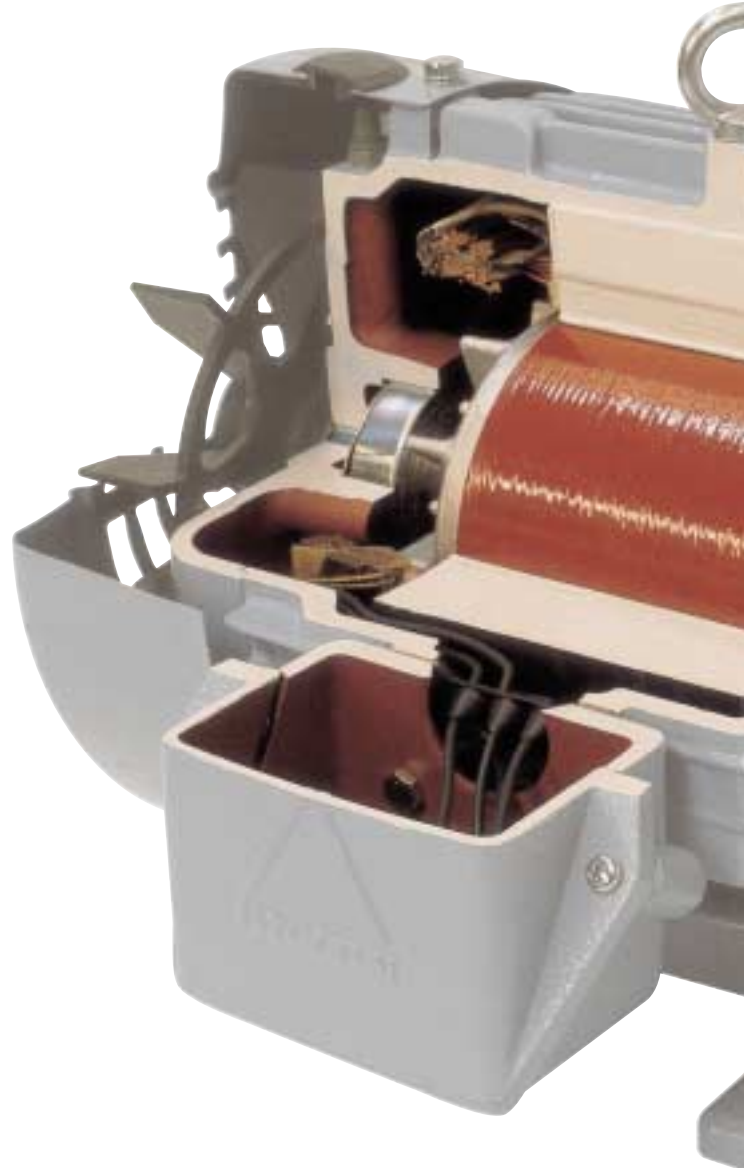

Frames 143T - 286T



Frames 324T - 326T



Premium Efficiency Motor

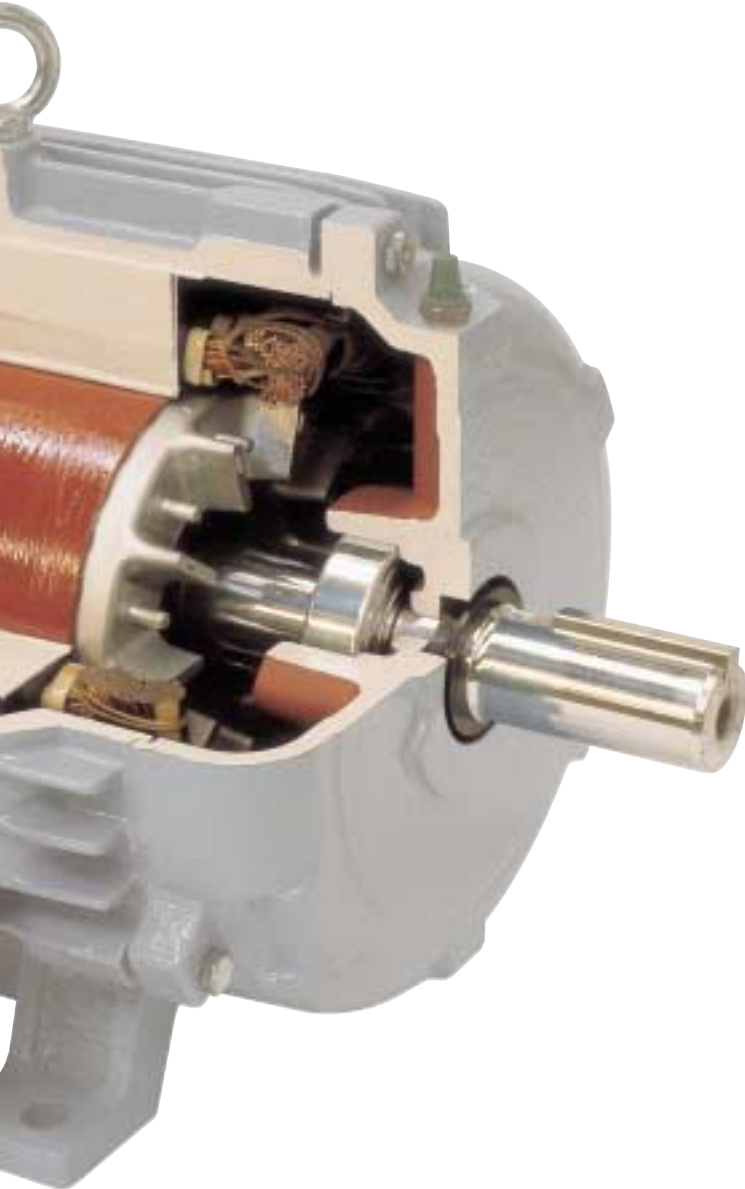

Frames 364T - 449TZ



Improved and Optimized Materials with More Features & Performance Benefits

- High grade, low loss, insulated electro-magnetic steel laminations are punched and core loss is controlled for maximum efficiency.
- Multiple dips and bakes in a high solid content Class H varnish system to promote excellent heat transfer and dissipation, providing extended insulation life.
- Superior Class F non-hygroscopic insulation system, utilizing corona resistant copper wire with a low stress winding process to protect against voltage spikes from IGBT inverters.
- Clearly numbered leads make connection easy.
- Die cast rotor of high conductivity aluminum eliminates variations in bar & end ring resistance. This assures consistent motor performance.
- Dynamically balanced rotor with half key ensures smooth operation, exceeding standard NEMA vibration requirements.
- Rotor surface is coated with corrosion resistant paint for outstanding resistance to severe environments.
- Prelubricated single shield bearings (286T & below) are adequately greased for life at the factory and do not need relubrication.
- Regreasable bearings (324T & larger) with integral grease fittings are shielded against contaminants with internal cast iron bearing caps.
- Drive end shaft slinger protects bearing system against contaminants.
- Oversized gasketed conduit box exceeding CSA, NEMA & NEC minimum volumes is diagonally split and fully rotatable at 90° increments.
- Neoprene lead gasket on conduit box protects motors against moisture and dust.
- Non-sparking, corrosion resistant external polypropylene fan assures best cooling and quieter operation.
- Plastic drain plugs, removable to allow condensation to drain from the motor.
- Corrosion resistant polyurethane paint and corrosion resistant zinc plated hardware protect motors against severe environments.

Canadian Motor Representative

Madison Industrial Equipment Ltd.

Vancouver :

TEL : (604) 872-8155
FAX : (604) 872-4563
Email : mmcroberts@madison.ca

Calgary :

TEL : (403) 938-9906
FAX : (403) 938-9928
Email : krehk@cadvision.com

Toronto :

TEL : (905) 612-9450
FAX : (905) 612-9451
Email : sales@madison-ont.com



SEOUL :

HYUNDAI BLDG, 140-2, GYE-DONG, JONGRO-GU
SEOUL, KOREA
TEL : 82-2-746-7518, 7627
FAX : 82-2-746-7648
E-mail : youngkim@hhi.co.kr

HEAD OFFICE :

1 JEONHA-DONG, DONG-GU
ULSAN, KOREA
TEL : 82-52-230-6601/6604, 8527/8
FAX : 82-52-230-6995, 8520